

INSTRUCTIONS FOR VARILIGHT EUROPEAN WIRING ACCESSORIES

VARILIGHT

This product must be installed in accordance with the current edition of the IET Wiring Regulations. **If in doubt, consult a qualified electrician.**

INSTALLATION

1. Always **switch OFF** the mains supply and remove the appropriate fuse or switch off the appropriate circuit breaker before beginning electrical work.
2. After removing from packaging, **place the product face down onto a soft cloth** or towel to prevent damage.
3. **Insert a screwdriver** into one of the short slots between the decorative plate and the clear plastic edge. **Twist gently one quarter turn** to release the plate.
4. Ensure the wall surface around the wall box is flat by **removing any lumps of plaster and sanding away any uneven areas.**
5. Always use cable of the correct rating and type.
6. The layout of the terminals may differ between fittings so **check the location of terminal connections carefully** before wiring.
7. **Connect wires to the appropriate terminals** on the rear of the switch assembly according to the relevant diagram, ensuring no bare wires protrude from the terminals.
8. If the product has an earth terminal, **connect the fixed earth wire to it** and then connect a short length of wire from the earth terminal on the product to the earth terminal on the wall box. The earth wire should be sheathed with green and yellow sleeving.

If using fixing screws:

9. **Fix the switch assembly** onto the wall box using the fixing screws supplied. **Tighten evenly a little at a time** until just tight enough to prevent movement of the back plate. Do not overtighten.

If using claw fixings instead of fixing screws:

10. Insert the screws into each side of the product and **place the product face down** on a clean surface.
11. **Slide the claws** onto the screws.
12. **Spin the rectangular nuts** onto the screws.
13. **Insert the product into the back box**, using the elastic bands to hold the claws steady, then tighten the screws to extend the claws until the product is secure. Do not overtighten.
14. Carefully **pick up the decorative front plate and push into place**, pressing gently on each side to ensure the front plate engages with the plastic clips on the switch assembly.
15. **Switch on the mains supply.**

1-Way Wiring

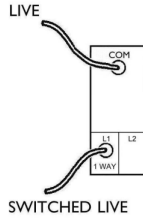

2-Way Wiring Options

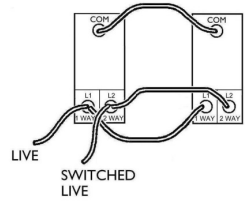

RTV Socket Wiring

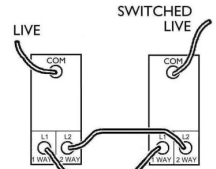
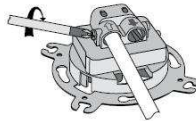

Intermediate Switch Wiring

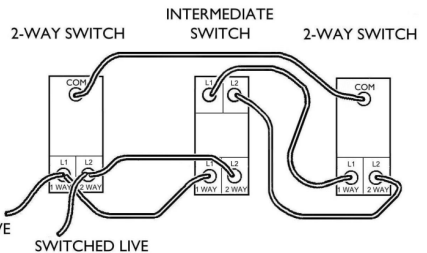

16A Push Fit Socket Wiring Example

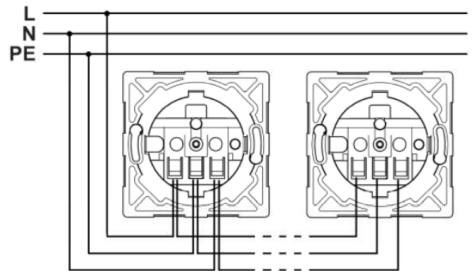

Claw System Fitting Example

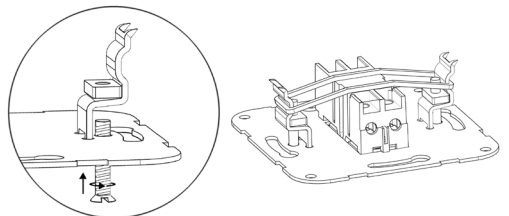

Doyle & Tratt Products Ltd, Carylls Lea, Faygate, Horsham
West Sussex, RH12 4SJ, UK. +44 (0)1293 223333
Varilight Europe Kft, H-2659 Ersekvadkert,
Petofi UT 1, HUNGARY



INSTRUCTIONS FOR VARIGRID WIRING ACCESSORIES

Please be aware, the instructions on this side are only for the VariGrid system. If you have a standard fixed European Varilight product, please turn this leaflet over.

VARILIGHT™

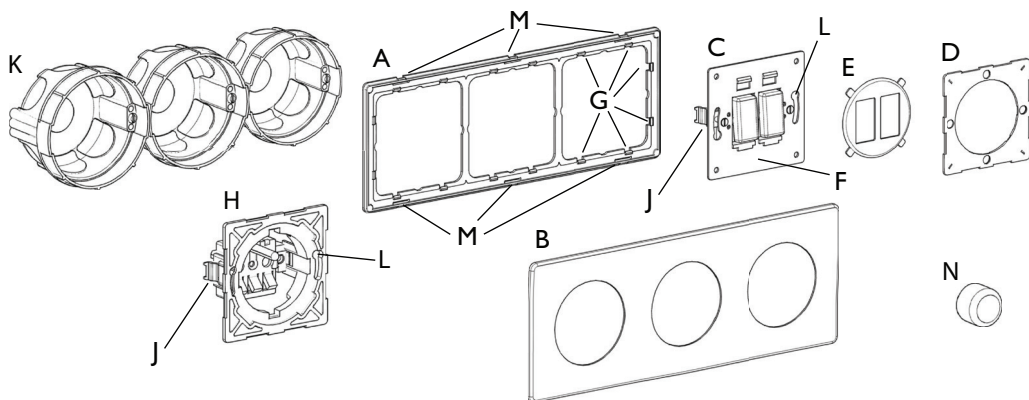

1. Remove the frame

- Unclip the plastic frame (A) from the rear of the decorative faceplate (B).
- Take an insert (C) and if fitting with claws remove the plastic cover plate (D) and metal fascia (E).
- 16A socket inserts: remove the central screw to release both parts of (D).
- Dimmers: remove the control knob(s) (N).
- Put (D) and (E) to one side.

2. Fit into the wall box and secure

- Position the clear plastic frame (A) against the wall
- Wire up and fix your first insert into the back box using either fixing screws or claws, being careful not to overtighten.

3. Repeat for all inserts

- Fit each insert into (A) the same way, then wire each insert following its wiring instructions.

4. Final tightening

- At this stage, go through and tighten all fixing screws or claws more firmly, ensuring the assembly is secure and aligned.
- 16A sockets: refit the central screw to secure both parts of (D).
- If fitting with claws, clip on the fascia (E)

5. Refit fascia and cover plate

- If using claws, fit each metal fascia (E) into the cover plate (D), then push (D) into place.

6. Clip on the decorative faceplate

- Align and clip the faceplate (B) onto the frame (A), pressing firmly over each external clip (M) until fully secure.

7. Finish (dimmers only)

- Refit the control knob(s) (N).

WARNING: Do not apply products with metal faceplates directly to freshly plastered or damp surfaces as product may tarnish. If in doubt, use polythene as a temporary gasket to protect the product. Do not use masking tape on metal faceplates.

Varilight Lifetime Guarantee

If this item becomes defective, Varilight undertakes to repair or replace the item, at its discretion, and solely as a result of faulty materials or workmanship, provided that the unit has been correctly fitted according to the instructions, has not been used overloaded beyond its rating, tampered with or taken apart. Pack the unit securely and return it to either address listed below, together with a proof of purchase, your contact details and return address, the type and wattage of the lighting or other load being controlled and the details of the fault. This guarantee states Varilight's entire liability, which does not extend to cover consequential loss or damage or installation costs arising from a defective product. This guarantee does not in any way affect the statutory rights of the purchaser and is offered so that you may have the benefit of our technical facilities. In many cases products don't need replacing, so for further information and help with troubleshooting, see our FAQ page at www.varilight.co.uk/faqs, or contact our Customer Services by calling +44 (01293) 223333 or create a support ticket at www.varilight.co.uk/help.

Guarantee Registration Number: VEU001